



**RECORD OF TITLE
UNDER LAND TRANSFER ACT 2017
FREEHOLD
Search Copy**



R.W. Muir
Registrar-General
of Land

Identifier **WN8B/1479**
Land Registration District **Wellington**
Date Issued 14 October 1970

Prior References
WNB2/120

Estate Fee Simple
Area 614 square metres more or less
Legal Description Lot 55 Deposited Plan 23615

Registered Owners

Grant Jason Robertson as to a 1/2 share
Suzanne Dawn Edwards as to a 1/2 share

Interests

Appurtenant hereto is a right to discharge surface water specified in Easement Certificate 520946
The easements specified in Easement Certificate 520946 are subject to Section 37 (1) (a) Counties Amendment Act 1961
Subject to Section 59 Land Act 1948
Subject as to the part shown coloured blue on Plan 23615 to the right to discharge surface water appurtenant to Lots 56 and 57 Plan 23615 and Lots 58 to 67 inclusive on Plan 23616
Subject to Section 37 (1) (a) Counties Amendment Act 1961
474052 Notice imposing Building Line Restriction
12064968.2 Mortgage to ASB Bank Limited - 26.3.2021 at 11:26 am

To Purchasers/Interested Parties:

A title shows evidence of events relating to a piece of real estate. A solicitor is the most appropriate person to examine a title. In accepting this title copy from Professionals, Redcoats Limited, you agree that this agency or any of its agents take no responsibility for interpreting it or for providing legal advice on anything out of the ordinary such as, but not limited to:

Caveat, Charging Order, Easement, Encumbrance, Instruments, Restrictive Covenant,
Covenant, Cross Lease, Joint Tenancy, Tenancy in Common, Company Share

Often more than just the title needs to be searched. Cross Lease, Consent Notices, Easements, Instruments and other documents may place restrictions on use. You should take guidance from a solicitor.

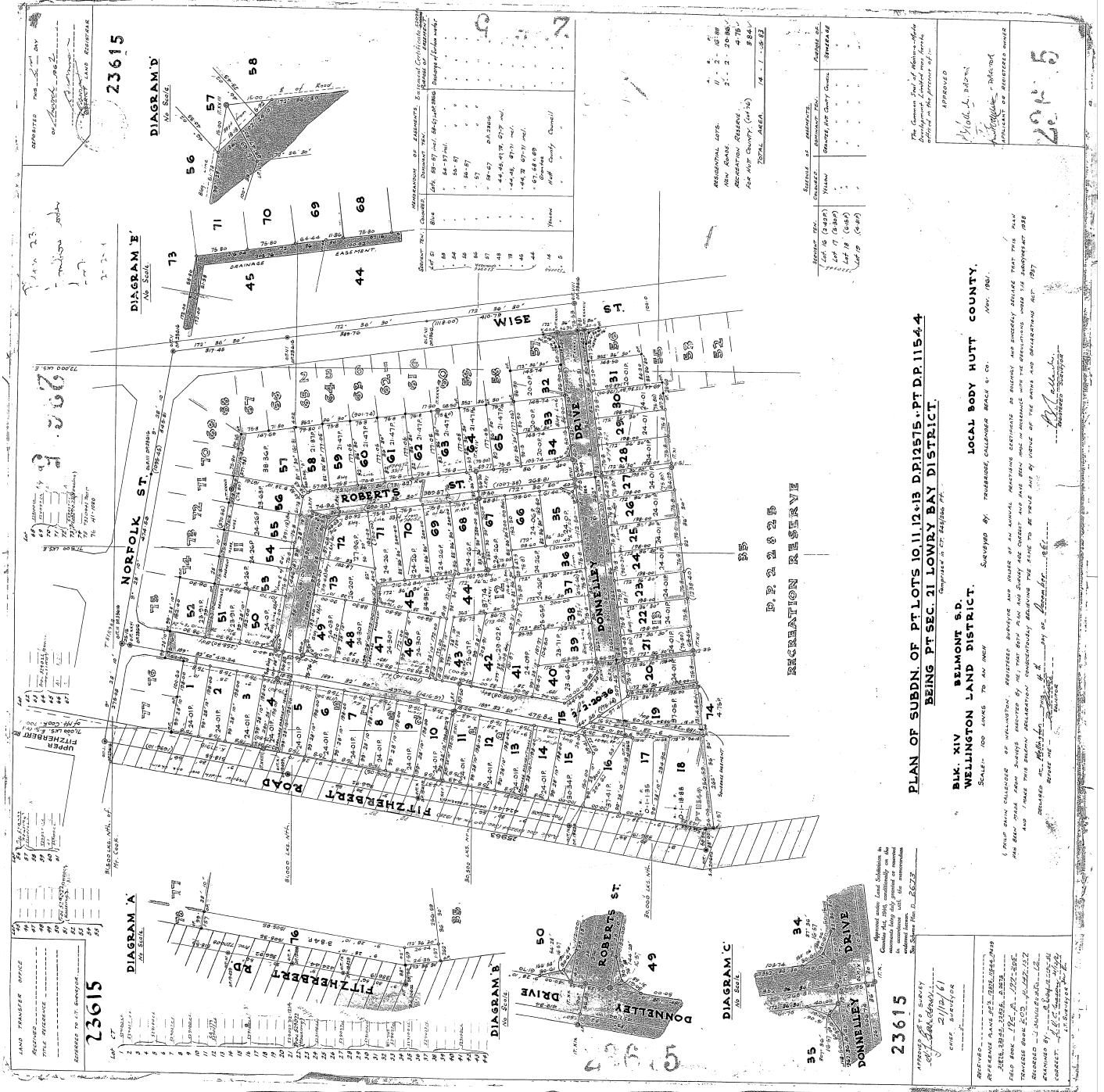

LAND TRANSFER OFFICE

RECEIVED

23615

DIAGRAM A

NO. 23615

DIAGRAM B

NO. 23615

DIAGRAM C

NO. 23615

DIAGRAM D

NO. 23615

DIAGRAM A

NO. 23615

DIAGRAM B

NO. 23615

DIAGRAM C

NO. 23615

DIAGRAM D

NO. 23615

DIAGRAM A

NO. 23615

DIAGRAM B

NO. 23615

DIAGRAM C

NO. 23615

DIAGRAM D

NO. 23615

DIAGRAM A

NO. 23615

DIAGRAM B

NO. 23615

DIAGRAM C

NO. 23615

DIAGRAM D

NO. 23615

DIAGRAM A

NO. 23615

DIAGRAM B

NO. 23615

DIAGRAM C

NO. 23615

DIAGRAM D

NO. 23615

DIAGRAM A

NO. 23615

DIAGRAM B

NO. 23615

DIAGRAM C

NO. 23615

DIAGRAM D

NO. 23615

DIAGRAM A

NO. 23615

DIAGRAM B

NO. 23615

DIAGRAM C

NO. 23615

DIAGRAM D

NO. 23615

DIAGRAM A

NO. 23615

DIAGRAM B

NO. 23615

DIAGRAM C

NO. 23615

DIAGRAM D

NO. 23615

DIAGRAM A

NO. 23615

DIAGRAM B

NO. 23615

DIAGRAM C

NO. 23615

DIAGRAM D

NO. 23615

LAND TRANSFER OFFICE

RECEIVED

23615

DIAGRAM A

NO. 23615

DIAGRAM B

NO. 23615

DIAGRAM C

NO. 23615

DIAGRAM D

NO. 23615

DIAGRAM A

NO. 23615

DIAGRAM B

NO. 23615

DIAGRAM C

NO. 23615

DIAGRAM D

NO. 23615

DIAGRAM A

NO. 23615

DIAGRAM B

NO. 23615

DIAGRAM C

NO. 23615

DIAGRAM D

NO. 23615

DIAGRAM A

NO. 23615

DIAGRAM B

NO. 23615

DIAGRAM C

NO. 23615

DIAGRAM D

NO. 23615

DIAGRAM A

NO. 23615

DIAGRAM B

NO. 23615

DIAGRAM C

NO. 23615

DIAGRAM D

NO. 23615

DIAGRAM A

NO. 23615

DIAGRAM B

NO. 23615

DIAGRAM C

NO. 23615

DIAGRAM D

NO. 23615

DIAGRAM A

NO. 23615

DIAGRAM B

NO. 23615

DIAGRAM C

NO. 23615

DIAGRAM D

NO. 23615

DIAGRAM A

NO. 23615

DIAGRAM B

NO. 23615

DIAGRAM C

NO. 23615

DIAGRAM D

NO. 23615

DIAGRAM A

NO. 23615

DIAGRAM B

NO. 23615

DIAGRAM C

NO. 23615

DIAGRAM D

NO. 23615

PLAN OF SUBDN. OF PLOTS 10, 11, 12, 13, 14, 15, 16, 17, 18, 19, 20, 21, 22, 23, 24, 25, 26, 27, 28, 29, 30, 31, 32, 33, 34, 35, 36, 37, 38, 39, 40, 41, 42, 43, 44, 45, 46, 47, 48, 49, 50, 51, 52, 53, 54, 55, 56, 57, 58, 59, 60, 61, 62, 63, 64, 65, 66, 67, 68, 69, 70, 71, 72, 73, 74, 75, 76, 77, 78, 79, 80, 81, 82, 83, 84, 85, 86, 87, 88

BEING PT SEC. 21 LOWRY BAY DISTRICT.

BLK. XIV BELMONT S.D.
WELLINGTON LAND DISTRICT.

SCALE: 100 FEET TO AN INCH

PREPARED BY: THESSER, CHAMBERLAIN & CO. (INCORPORATED)

LOCAL BODY HUTT COUNTY.

I HEREBY CERTIFY THAT THIS PLAN HAS BEEN MADE IN ACCORDANCE WITH THE REQUIREMENTS OF THE LAND ACT 1924 AND THE SUBDIVISION ACT 1908.

APPROVED BY THE COMMISSIONER OF LANDS AND SURVEYS:

21/07/61

23615